

Manual

Application of the iron-on paper on black and dark textiles

The paper is designed for transferring prints onto black and dark textiles such as T-shirts, bags, mouse pads etc.

What you need:

- 1) Press-on paper for dark textiles
- 2) Inkjet printer
- 3) A flat, hard, smooth ironing surface
- 4) Iron (not a travel iron)
- 5) Black or dark t-shirt, baseball cap, boxers, fabric-covered computer mouse pad, cotton handkerchief, neckerchief, bag, etc.
- 6) A sheet of plain office paper

Printing:

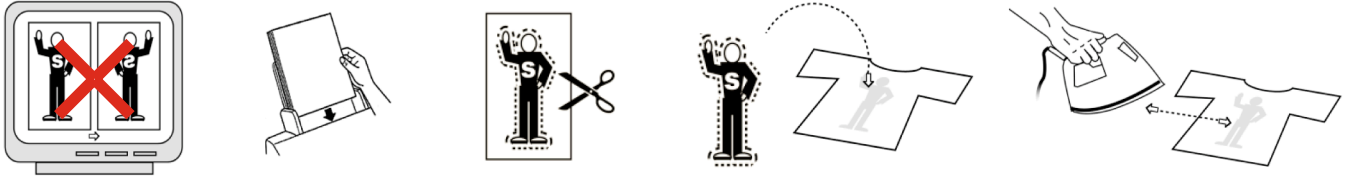

- Store the iron-on paper in its original packaging in a cool, dry place.
 - Print only on the blank side of the iron-on paper.
- It is recommended to enable **the best print quality** in the printer (e.g. Photo Quality / Photo Quality).

Do not enable the 'mirror image' printing mode. !!!

- Use only one sheet of iron-on paper in the printer tray.
- Print your desired design on plain paper first to check that the colours and print size are correct.
- Print your design on iron-on paper and leave it for approximately 1 minute for the ink to dry well before transferring.
- Cut out your image leaving a thin margin (about 5mm) around the edges.

Transferring:

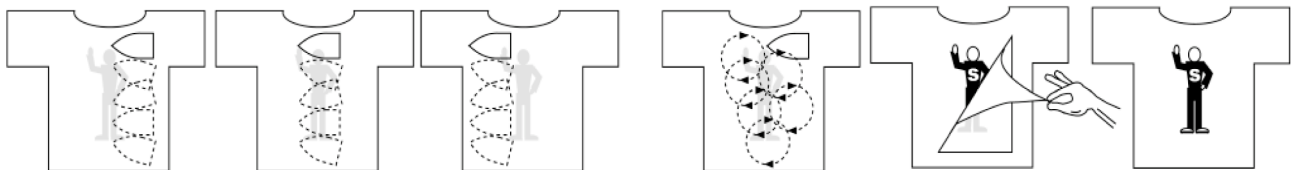

- Heat the iron to approximately 180-200°C (standard temperature stage II). Do not use the steam function!
You can also use a hot transfer press.

- Briefly iron the fabric to ensure it is smooth and crease-free.
- Carefully remove the bottom layer of the iron-on paper (the layer with the printed check).
- Place the iron-on paper on the fabric so that the print is seen correctly.
- Lay a plain sheet of paper over the iron-on fabric.
- Iron the paper with firm pressure and slow movements. Don't forget the edges and borders.

Possible dark brown discolouration of the paper is a sign that the iron temperature is too high.

Iron the paper for approx. 1.5 - 2 minutes (for an entire A4 sheet).

- Allow the iron-on paper to cool completely and then peel it off.

Washing:

- Wash the garment/fabric before wearing/using it.
- Wait 24 hours before washing for the first time after transferring
- Wash textiles at 30-40°C turned inside out.
- Do not use aggressive laundry detergents or any bleach.
- Do not use a spin-dryer.
- Iron only on the reverse side.